

## Roll-down fire doors and smoke curtains Champion Door Oy



Champion Door Fire doors and smoke curtains roll down when a fire alarm occurs. They effectively stop the fire from spreading from one part of the building to another.

Fire doors can be installed in such a way that they are unnoticeable, and they can be equipped with an external power supply.

Champion Door roll-down fire doors and smoke curtains

- comply with the EN1634-1 standard
- have been tested by the Technical Research Centre of Finland
- can be embedded in the building structure (remaining invisible when there is no alarm)
- function even if the regular power supply is out of order
- are manufactured to measure at the Champion Door factory in Finland



### Ideal locations for fire doors

Roll-down fire doors can be especially adapted to

- shopping malls
- museums
- airports
- hotels
- restaurants

- night clubs
- car parks
- industrial buildings
- conveyor openings
- tunnel openings
- building frontals, to protect them from fire in nearby buildings

## FIRE ROLLER DOOR MODEL CDF-E 120

An ideal fire door or smoke curtain effectively stops the fire from spreading from one fire compartment to another. The fabric, reinforced with glass fibre and steel wire rolls down from its protective housing when a fire or smoke alarm occurs. If there are buildings situated very close to each other, the fire door can also be installed in a window, to prevent the fire from spreading from one building to another.

The CDF-E 120 model can be equipped with a separate fire detection system, smoke and heat detectors and alarms. The door can be installed in the vicinity of a sprinkler system.

CDF-E 120 can also be connected to an existing fire detection system. It has its own fire alarm and warning light system.

CDF-E 120 can be equipped with a panic switch so that a person trapped behind the door can push and open the door sufficiently in order to get out. After a pre-programmable amount of time, the door closes again automatically.

The silver grey fire fabric is reinforced with glass fibre and steel wire and weighs 690 g/m<sup>2</sup>. The metal housings of the CDF-E 120 model are made of clear galvanized metal. They can also be painted in several colours (RAL).

### Test results

Champion Door Fire CDF-E 120 has been fire endurance tested according to the SFS-EN 1634-1 standard for fire resistance. The product complies with all applicable standards, and the test results are superior to the requirements of fire resistance class 120. Without sprinkler protection, the door conforms to class EW-20 when the safety distance is 1,5 meters. It conforms to class EW-30 when the safety distance is 2 meters.

Connected to a sprinkler system, the door can conform to fire resistance class EI after a safety approval.



Testing a fire door at a research centre

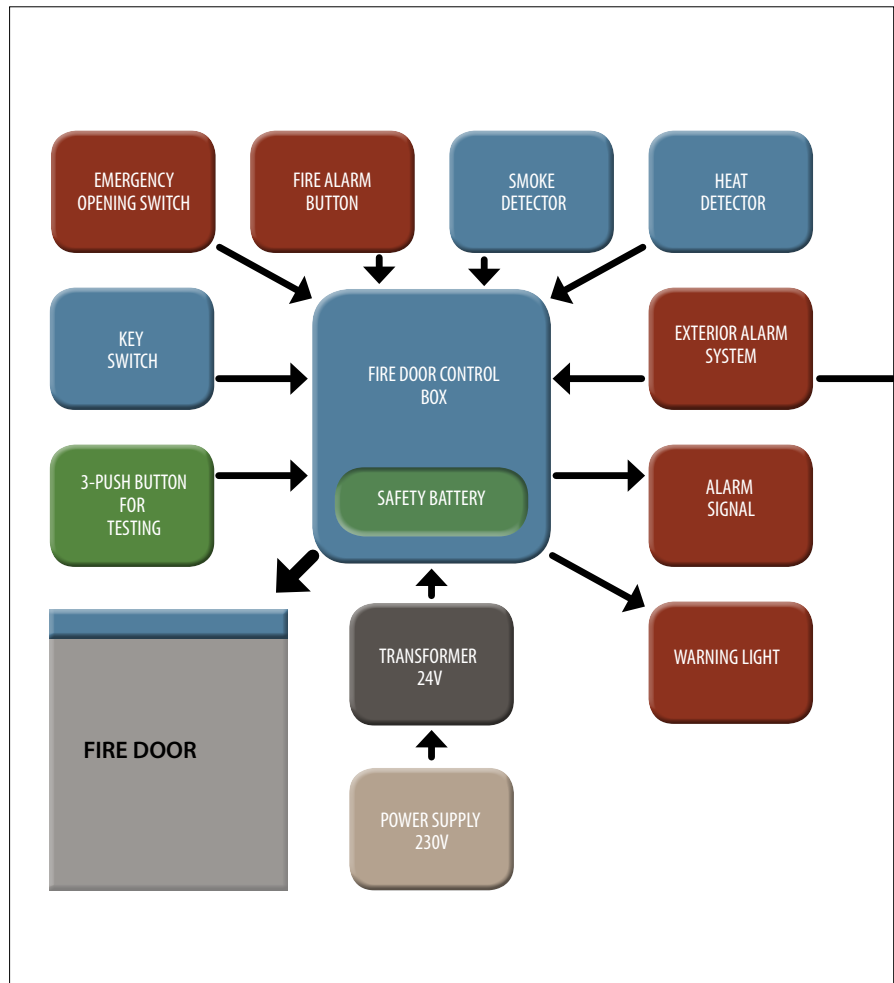

Operating scheme of the roll-down fire door



Roll-down fire door installed in a hotel corridor.

Hotel GLO (address: Aleksanterinkatu 40, Helsinki).

The fire safety inspection report made here shows that the Champion Door roll-down fire door conforms to fire resistance class EI 30, which is superior to fire resistance class E 120 requirements established by the Technical Research Centre of Finland.

## Technical information

- Operated by 24 V, 230 V or 400 V motors.
- 24 V motor has safety battery back-up, 230 V and 400 V motors can be equipped with an exterior power supply
- Weighs approximately 30 kg/m.
- Standard maximum size: width 34 m, height 8,5 m. Larger sizes can be custom-designed.
- Closing speed 0,05 to 0,15 m/s.
- Side guide rails and upper housing can be spray painted in RAL colours.
- Can be installed in existing building spaces because of the unique modular structure of the housings.
- Can be mounted in a ceiling, a wall or a suspended ceiling.
- Resists a temperature of 1100 °C for at least 120 minutes.

## Some locations for roll-down fire doors

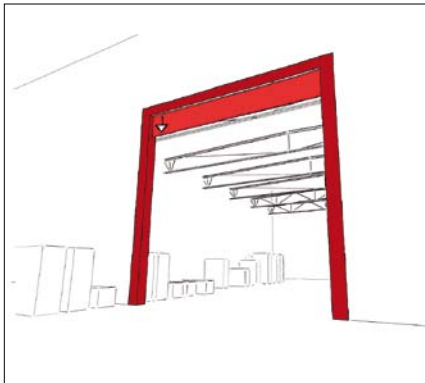

Between fire compartments of industrial buildings

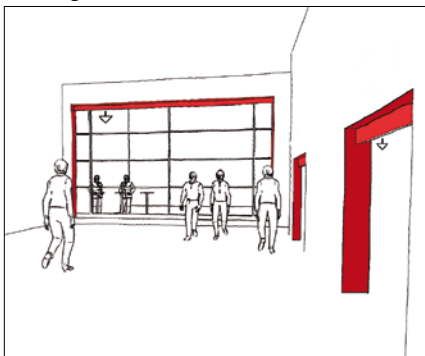

Door openings and glass walls of shopping malls

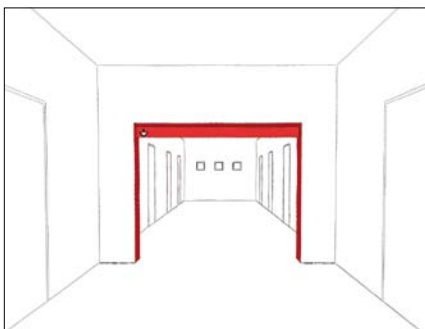

Corridors in hotels and office buildings



Large-sized doors allowing the passage of lifting machines.  
Miilukangas Oy, Raahе

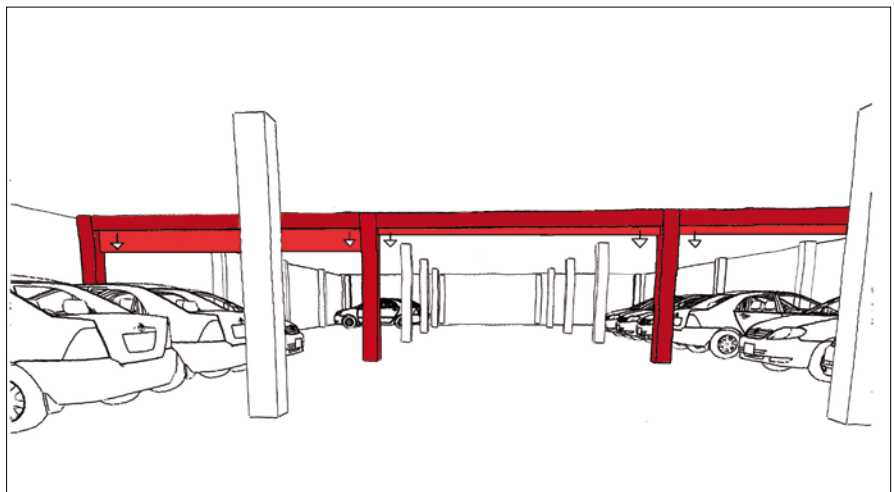

For fire compartments of car parks and warehouses

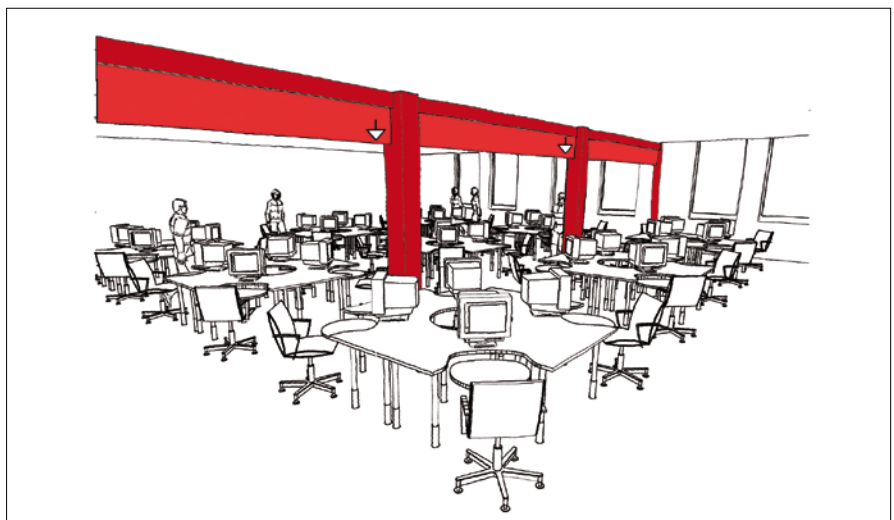

In open office space, embedded in the ceiling structure

## Installation

Because of its modular structure, the door can easily be embedded in ceiling and wall structures, with only the side guide rails visible.

Champion Door technicians install the doors quickly and professionally. The installation takes 1 to 5 workdays.

The following technical documents are provided with each door:

- user manual
- technical information
- maintenance register
- EU certificate and other required certificates.

## SMOKE CURTAIN MODEL CDF-S

- Made of fire resistant fabric.
- Extracts fumes and directs them outside the building to minimize smoke damage.
- Motor-operated
- Can be connected to a fire alarm system.
- Closing height can be pre-programmed in order not to hinder movement below

### Technical information

- fabric weight 455 g/m<sup>2</sup>
- operating temperature -36 °C to +150 °C
- fabric heat resistance 600 °C
- colour silver grey

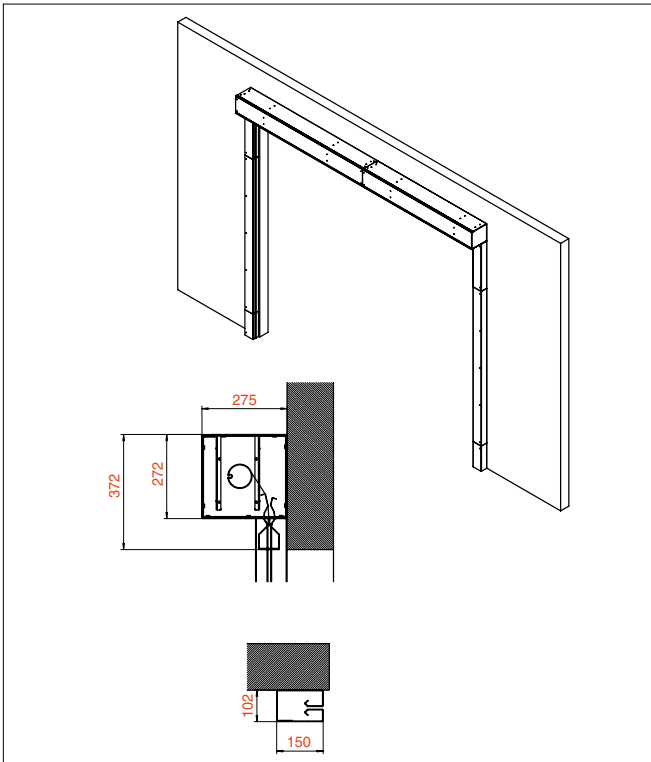

Installation in a wall

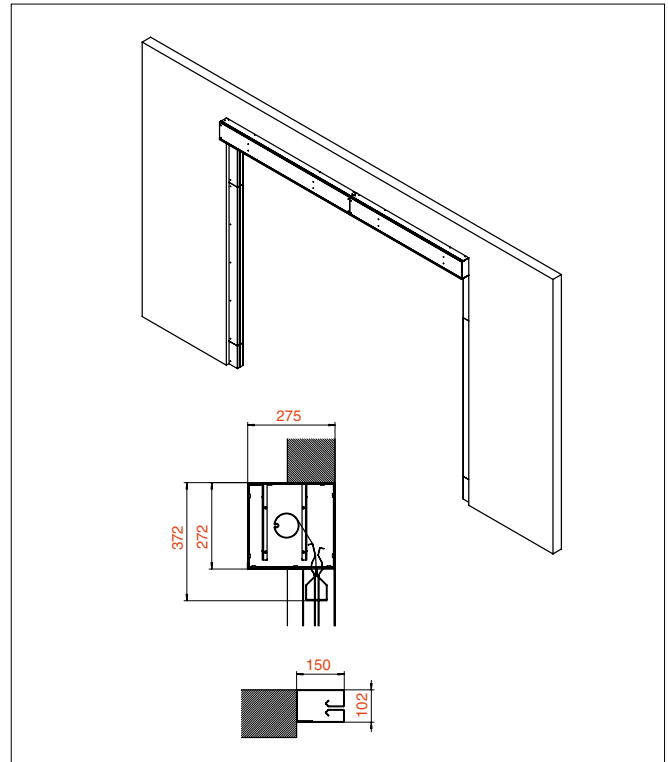

Installation in an opening



The upper housing of a roll-down fire door



Components are manufactured using laser technology



CDF-E 120 is well suited to narrow staircases



Bottom beam and side housing

## MANUFACTURING AND SALES

Champion Door Oy  
 Pajatie 1  
 FI-85500 NIVALA, FINLAND  
 Tel. +358 (0)8 445 8800  
 Fax +358 (0)8 442 956  
 info@championdoor.com  
 www.championdoor.com

